



## DRAPERY PRICE LIST

1.	FRONT OR BACK WALL -----	\$400
2.	SIDE WALL -----	\$600
3.	GLASS WALL ( WITH OR WITHOUT BAR OPENING) -----	\$600
4.	FRONT DOOR -----	\$250
5.	3 WALLS ( GLASS WALLS OPEN) -----	\$1200
6.	FULL ROOM WITH DOOR -----	\$1900
7.	ACROSS THE MIDDLE W/ 1 OPENING -----	\$500
8.	ACROSS THE MIDDLE MULTIPLE OPENINGS -----	\$700
9.	1 SIDED TUNNEL TO THE MIDDLE WITH OPENING -----	\$450
	<i>+ACROSS THE MIDDLE TO USE BACK HALF (\$300)</i>	
10.	2 SIDED TUNNEL TO THE MIDDLE WITH OPENING -----	\$650
	<i>+ACROSS THE MIDDLE TO USE BACK HALF (\$300)</i>	
11.	FRONT TO BACK (CUT OFF ROOM FOR INTIMATE DINING RENTALS) --	\$400
12.	4 SIDE CANOPY ( OPEN OR CLOSED SIDES) -----	\$450
13.	INSIDE GLASS OF INTIMATE DINING ROOM -----	\$250
14.	INSIDE GLASS OF CONFERENCE ROOM -----	\$200

BUNDLE PRICING MAY APPLY

ADDITIONAL OPTIONS AVAILABLE UPON REQUEST

\*PRICING MAY VARY FOR CUSTOM COLORS



TAYLOR'D GARDEN

# FLOOR PLAN

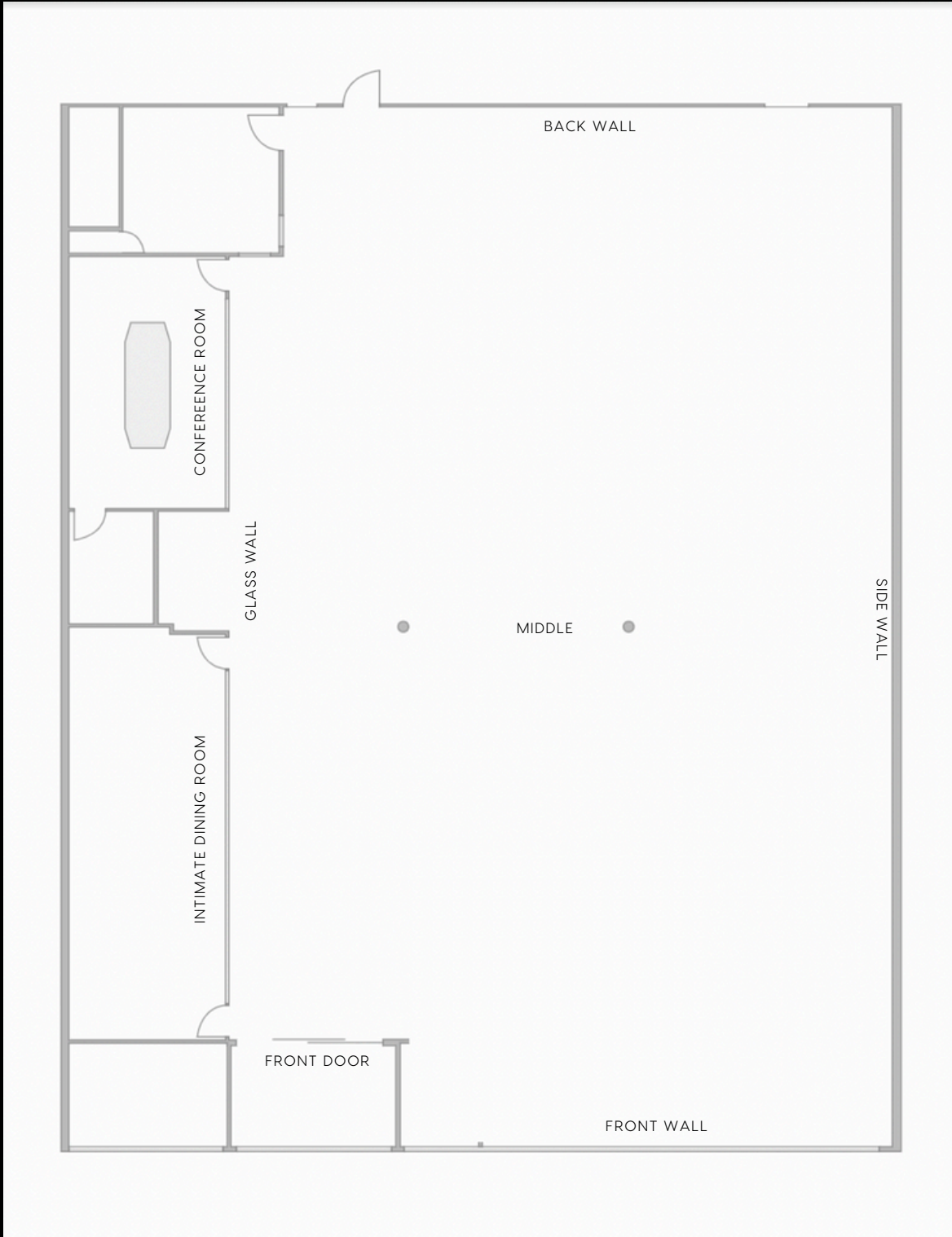

# TG

TAYLOR'D GARDEN

## EXAMPLES



1.



2.



3.



4.



5.

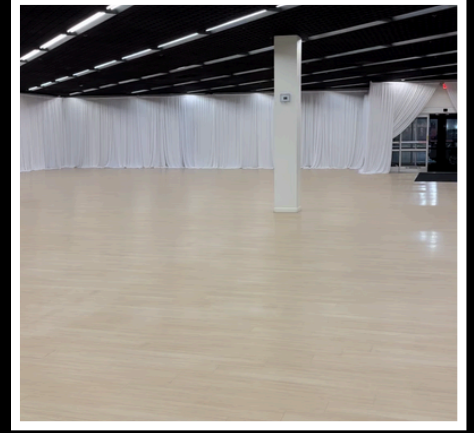

6.

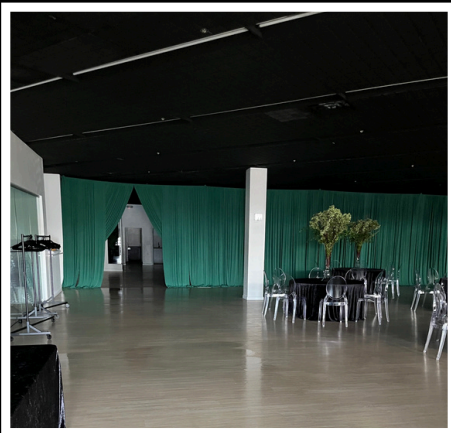

7.



8.



9.

## EXAMPLES



10.



11.



12.



13.

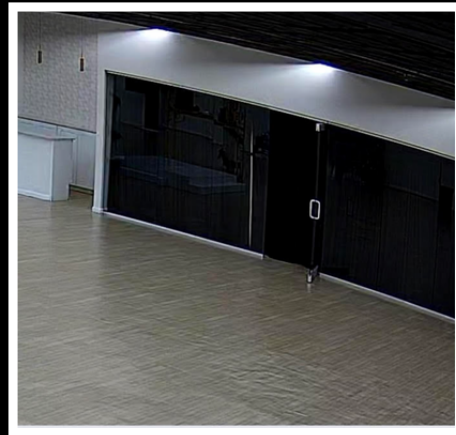

14.